



## DOME SPECS:

Load capacity per arch:  
1200kg

Wind threshold:  
90kmph

Height at Apex:  
10m (to truss)

Internal width:  
20m

Bay spacing:  
3m

Usable floor length:  
36m

Usable floor space:  
720 SQM

Empty stage space:  
17m x 8.4m (+- 140 SQM)

2 x black drapes:  
20m x 8m

Power:  
100amp 3 phase

Doors:  
6 x double emergency exit doors

Ground plan:

[Click here.](#)

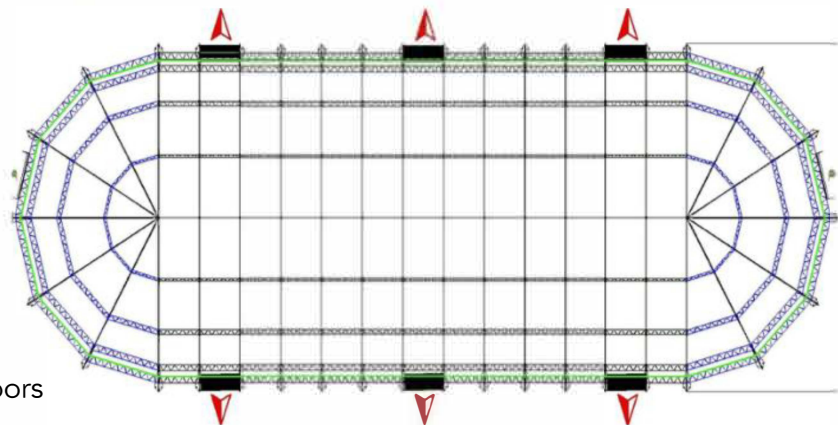
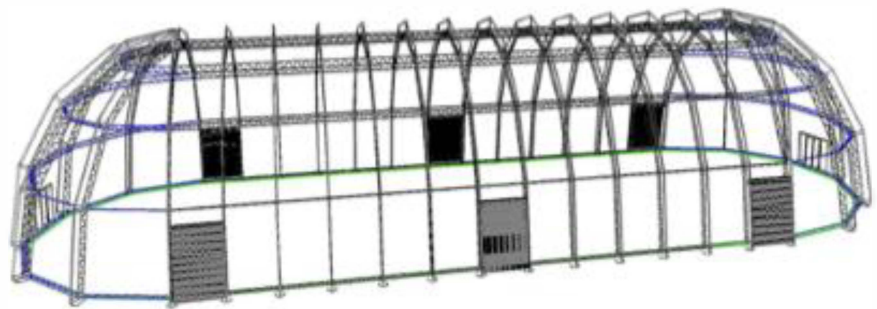
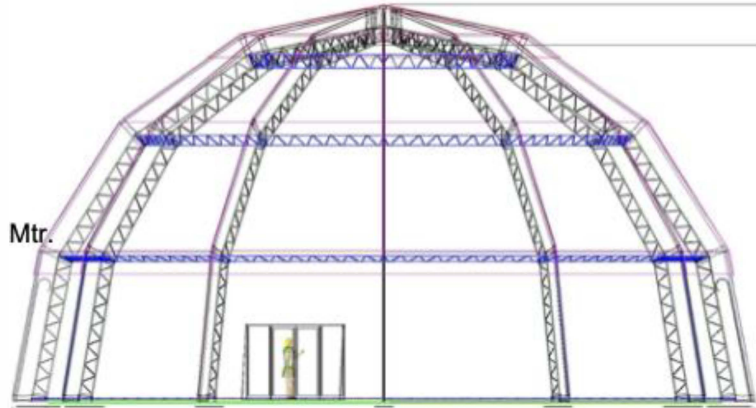

Zip Zap Circus School Trust, Cape Town

6 Shannon Street, Salt River, 7925 **Tel:** +27 21 421 8622 **Fax:** +27 86 517 4362 **Web:** www.zip-zap.co.za **Email:** info@zip-zap.co.za

Trust IT3447/98 | Non-Profit Organisation 037-198 | PBO 930 028 436 | Level 1 BBBEE contributor

**Co Founders & Trustees:** Laurence Esteve, Brent van Rensburg

EMPOWERING KIDS FOR LIFE



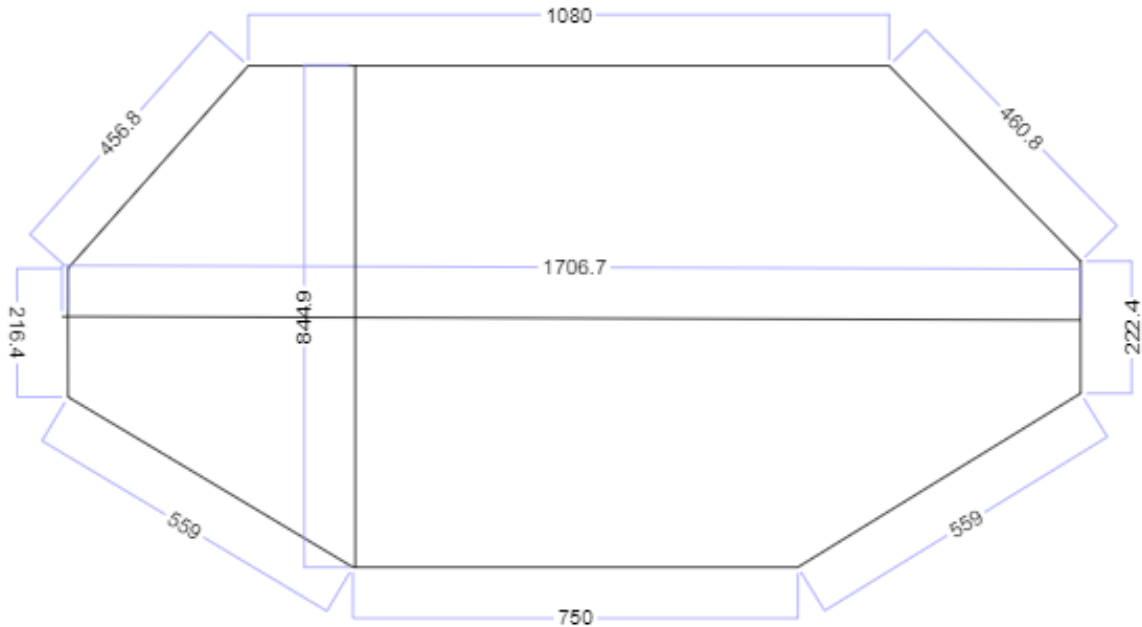

Zip Zap Dome Stage 1 – measurements are in Metres (m)

## TECHNICAL RIDER:

### Lighting:

- X6 Robin 100
- X2 Robin DLX spot
- X12 ledforcepar18
- X11 F1 Longman
- X1 lighting console (DOT2 CORE)

### Built in Stage:

- 17m x 8.4m x 750cm approx.

### Winches:

- 1 centre stage
- 1 stage left

### Sound:

- Allen and heath mixer 6 channel
- X2 electro voice professional power amplifier Q1212
- X1 electro voice DC ONE 24 BIT DIGITAL sound system processor
- X6 electro voice tops
- X2 electro voice sub
- X2 Shure handle mic

Zip Zap Circus School Trust, Cape Town

6 Shannon Street, Salt River, 7925 **Tel:** +27 21 421 8622 **Fax:** +27 86 517 4362 **Web:** www.zip-zap.co.za **Email:** info@zip-zap.co.za

Trust IT3447/98 | Non-Profit Organisation 037-198 | PBO 930 028 436 | Level 1 BBBEE contributor

**Co Founders & Trustees:** Laurence Esteve, Brent van Rensburg

EMPOWERING KIDS FOR LIFE

